

EASTSIDE PHASE 1



Lot 8, Block 9, Plan 0913590

(1107 9th Avenue S.E.)

- \$106,600.00 plus GST
- R-2 Low Density Residential District
- No discounts for right-of-ways to apply as they have been taken into consideration at the time of pricing.
- Fully Serviced

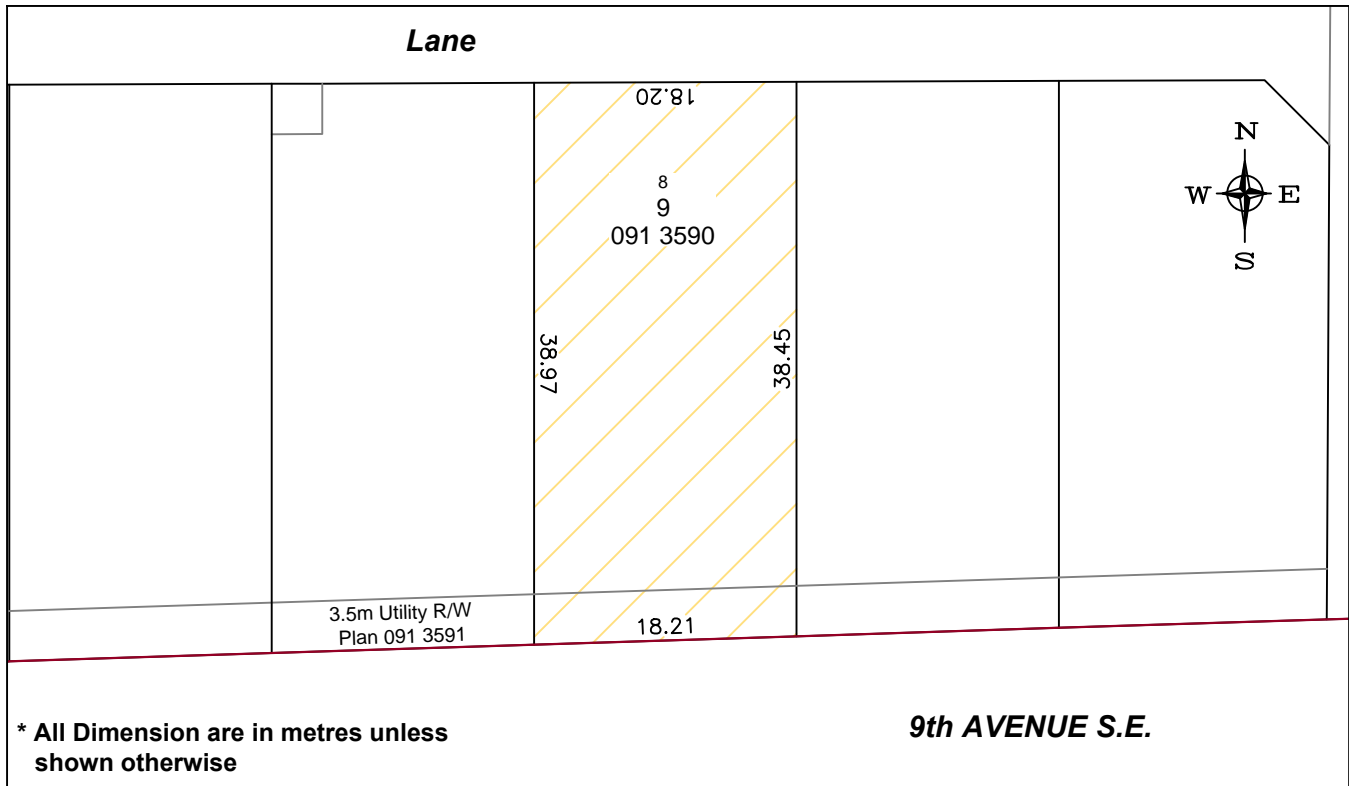

CAUTION
BOUNDARY INFORMATION PRODUCED FROM ALTALIS,
NOVEMBER 2010.
NOT BASED ON ACTUAL SURVEY.

AREA = 704.40m²
0.17 Acres

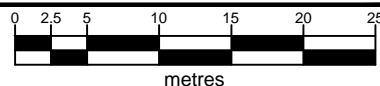

TOWN OF REDCLIFF